

Exporting a Copy of your Course from Canvas

CTLT recommends creating and keeping an exported copy of your course so that you can reuse the content. The best time to export a copy is at the end of the term when most of content has been uploaded to the course.

Login to the course, then follow the steps below.

Step 1

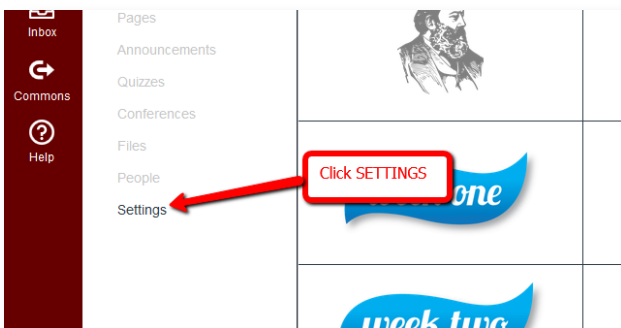

Step 2

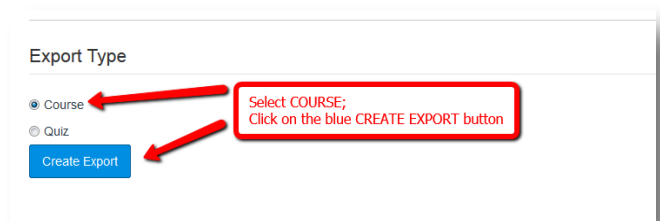

Step 3

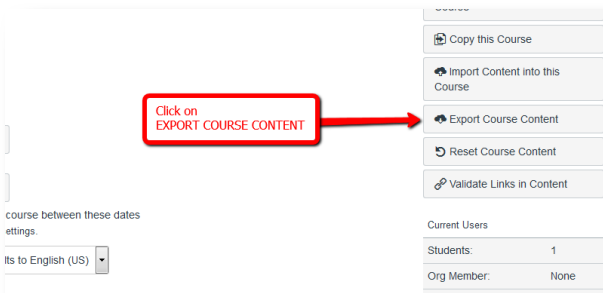

Step 4

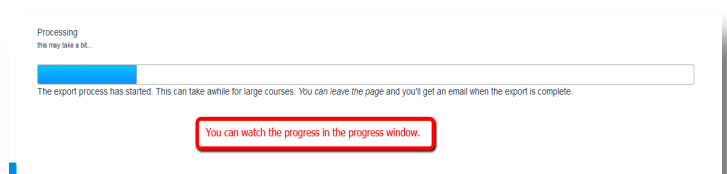

Step 5

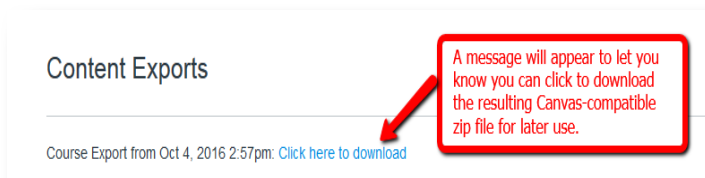

For help with exporting a copy of your course from Canvas, please email ghoffman@su.edu.